

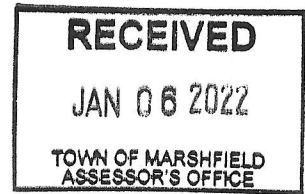

Town of Marshfield
 Assessor's Office
 870 Moraine Street
 Marshfield, Massachusetts 02050-3498
 781-834-5585



Paid check

REQUEST FOR CERTIFIED ABUTTERS LIST

MAP D08 BLOCK 01 LOT 11A

PARCEL ADDRESS REQUESTED Commerce Way

RECORD OWNER VRT Corp, 80L Washington Square, Norwell, MA, 02061-1729

CONTACT PERSON Paul Momnie TELEPHONE# 617-574-3832

CONTACT MAILING ADDRESS 400 Atlantic Avenue, Boston, MA 02110

CONTACT EMAIL ADDRESS pmomnie@goulstonstorrs.com

SIGNATURE *Paul Momnie* DATE 1/4/2021

COST: \$25.00

Planning Board

- Special Permit- 300 ft abutter to abutter
- Subdivision- 300 ft abutter to abutter
- Street Improvement - direct abutters

Zoning Board of Appeals - 300 ft abutter to abutter

- Conservation Commission - 100 ft
- Other - _____

For Street Improvement, please list streets being improved.

CERTIFIED LIST OF ABUTTERS

The attached abutters list has been prepared under MGL Chapter 40A § 11 or MGL Chapter 131 § 40, as applicable, to certify that at the time of the last assessment for taxation made by the Town of Marshfield that the names and addresses provided are the assessed abutting owners based on the distance noted above to the parcel of land requested above.

Certified By:

John L. Linn
 Marshfield Assessor's Office

1/6/2022
 Date

NOTE: This abutter's list will be valid for three (3) months from the date of signature. Green cards received from notified abutters are to be returned to the appropriate office prior the public hearing.

Please be aware that per Massachusetts General Law (G. L. c 66, § 10) this office has up to 10 calendar days to fulfill this request. You will be contacted by phone or email when the list is completed

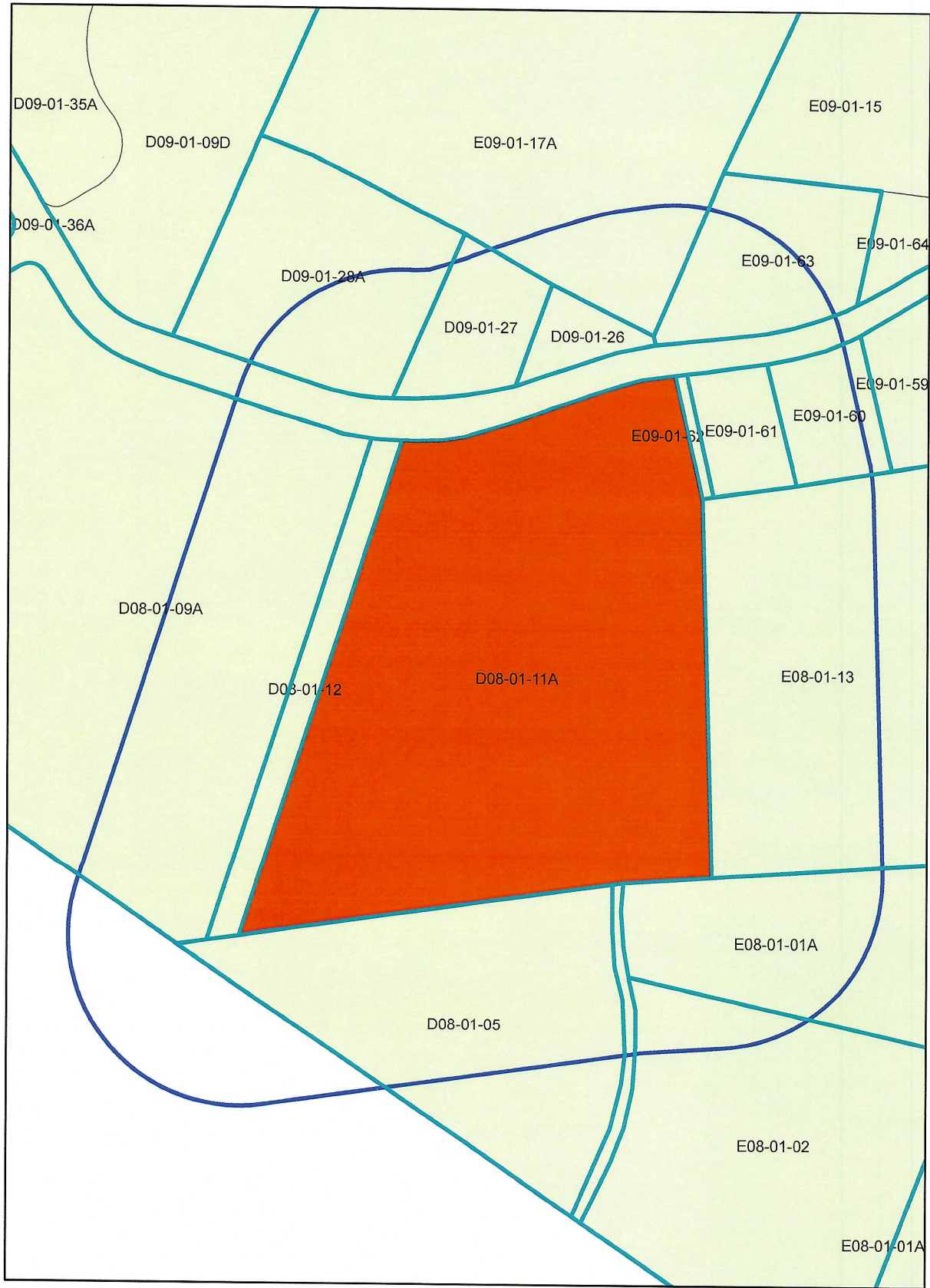

200 COMMERCE WAY D08-01-09A

LUC: 112

CIP18 MARSHFIELD MEWS LLC
500 EAST BROWARD BLVD #1130
FT LAUDERDALE, FL 33394

COMMERCE WAY

E09-01-60

LUC: 440

VRT CORP
80 L WASHINGTON SQUARE
NORWELL, MA 02061-1729

COMMERCE WAY D08-01-11A

LUC: 440

VRT CORP
80 L WASHINGTON SQUARE
NORWELL, MA 02061-1729

COMMERCE WAY

E09-01-61

LUC: 440

VRT CORP
80 L WASHINGTON SQUARE
NORWELL, MA 02061-1729

COMMERCE WAY D08-01-12

LUC: 442

VRT CORP
80 L WASHINGTON SQUARE
NORWELL, MA 02061-1729

COMMERCE WAY

E09-01-62

LUC: 442

VRT CORP
80 L WASHINGTON SQUARE
NORWELL, MA 02061-1729

COMMERCE WAY D09-01-26

LUC: 440

VRT CORP
80 L WASHINGTON SQUARE
NORWELL, MA 02061-1729

COMMERCE WAY

E09-01-63

LUC: 440

VRT CORP
80 L WASHINGTON SQUARE
NORWELL, MA 02061-1729

65 COMMERCE WAY D09-01-27

LUC: 400

SMITH ROBERT M TR
RMS REALTY TRUST
56 MOUNCE FARM WAY
MARSHFIELD, MA 02050-0000

125 COMMERCE WAY D09-01-28A

LUC: 401

COMMERCE WAY REALTY LLC
106 LONGWATER DR
NORWELL, MA 02061

REAR MOUNT SKIRGO E08-01-01A

LUC: 930

TOWN OF MARSHFIELD DPW
870 MORAIN STREET
MARSHFIELD, MA 02050

OLD MOUNT SKIRGO REAR E08-01-02

LUC: 932

TOWN OF MARSHFIELD CON COMM
MARSHFIELD, MA 02050

OLD MOUNT SKIRGO REAR E08-01-13

LUC: 932

TOWN OF MARSHFIELD CON COMM
870 MORAIN STREET
MARSHFIELD, MA 02050

89 ROCKWOOD ROAD E09-01-17A

LUC: 930

TOWN OF MARSHFIELD
870 MORAIN STREET
MARSHFIELD, MA 02050

Duxbury Assessing Department
878 Tremont St.
Duxbury, MA 02332

Board of Assessors
James G. MacNab, Chairman
Nancy D. Reed, Vice Chairman
Linda M. Collari, Clerk

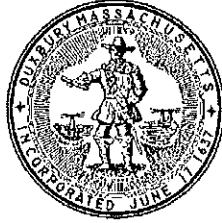

Telephone: (781) 934-1100
EXT: 6010
FAX: (781) 934-2402

Stephen J. Dunn, RMA, RA
MA Certified Res. Appraiser #533
Director of Assessing
dunn@town.duxbury.ma.us

22 JAN 6 AM 11:00

DUXBURY MA ASSESSORS

ABUTTER LIST REPORT
(Please allow 10 days for final list)

MAP: D08 (Marshfield) BLOCK: 01 LOT: 11A

PARCEL ADDRESS REQUESTED: Commerce Way, Marshfield, MA

RECORD OWNER: VRT Corp, 80L Washington Square, Norwell, MA, 02061-1729

CONTACT PERSON: Paul Monnie TELEPHONE#: (617) 574-3832

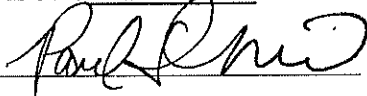
SIGNATURE  DATE 1/4/2021

COST: \$30.00 FOR EACH PARCEL REQUESTED (Due with request form)

Direct Abutter 100' - Conservation 300' - Zoning 500'

CERTIFIED LIST OF ABUTTERS

The attached abutters list has been prepared under MGL Chapter 40A§11 to certify that at the time of the last assessment for taxation made by the Town of Duxbury, that the names and addresses provided are the assessed abutting owners based on the distance noted above to the parcel of land requested above.

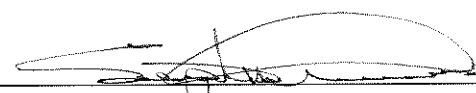
Director of Assessing

Date 1/6/22

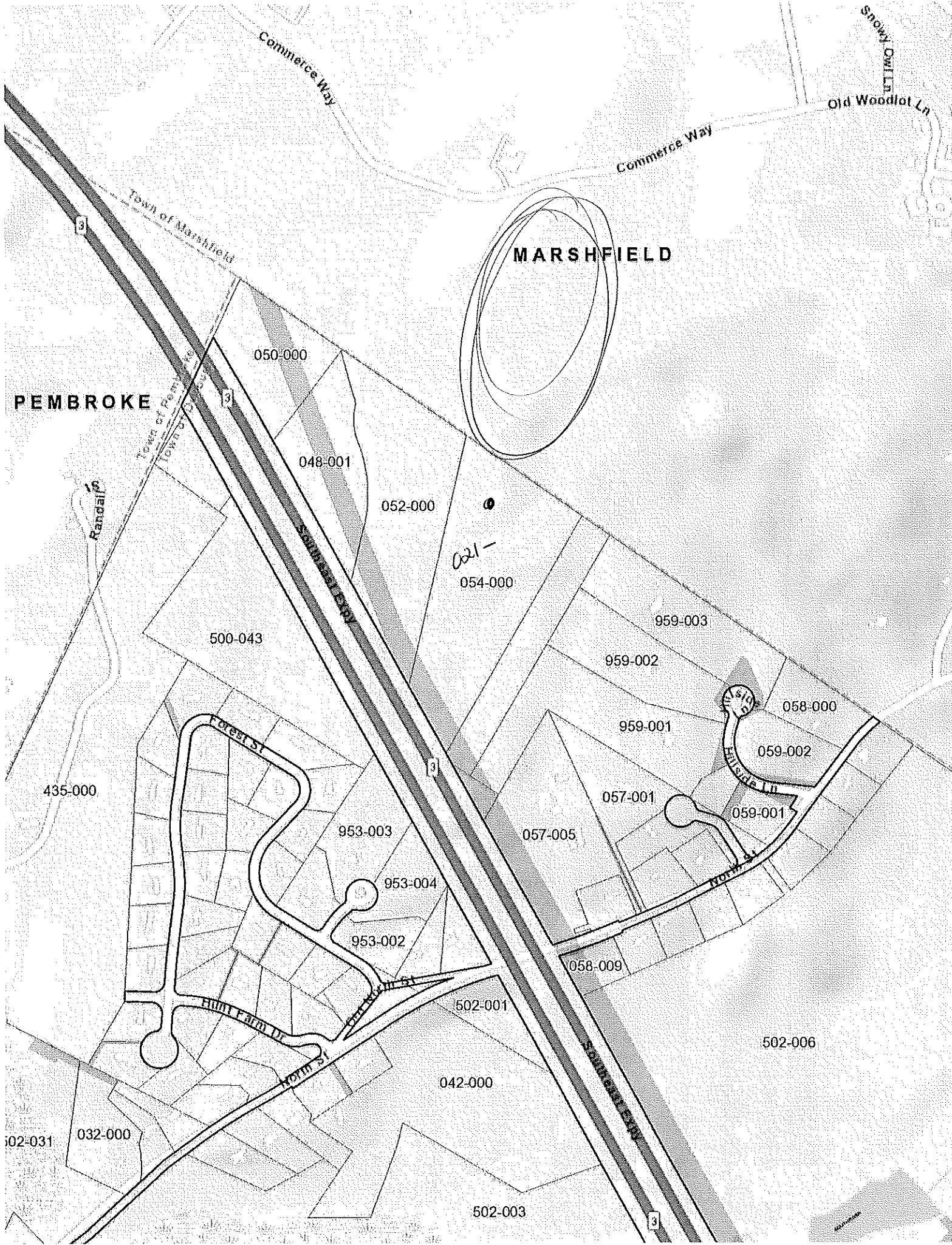

PEMBROKE

MARSHFIELD

050-000

048-001

052-000

021 -

054-000

500-043

959-003

959-002

058-000

059-002

435-000

959-001

059-001

953-003

057-005

953-004

502-001

953-002

058-009

502-006

042-000

502-003

502-031

032-000

Commerce Way

Commerce Way

Old Woodlot Ln

Snowy Owl Ln

Town of Marshfield

Town of Pembroke

Town of Danvers

Randall Rd

Forest St

Hunt Farm Dr

North St

SUNNYSIDE DRIVE

SUNNYSIDE DRIVE

Sunnyside Ln

North St

3

3

3

3



Map 021 Block 054 Lot 000

Duxbury, MA

1 inch = 279 Feet



January 6, 2022

www.cai-tech.com

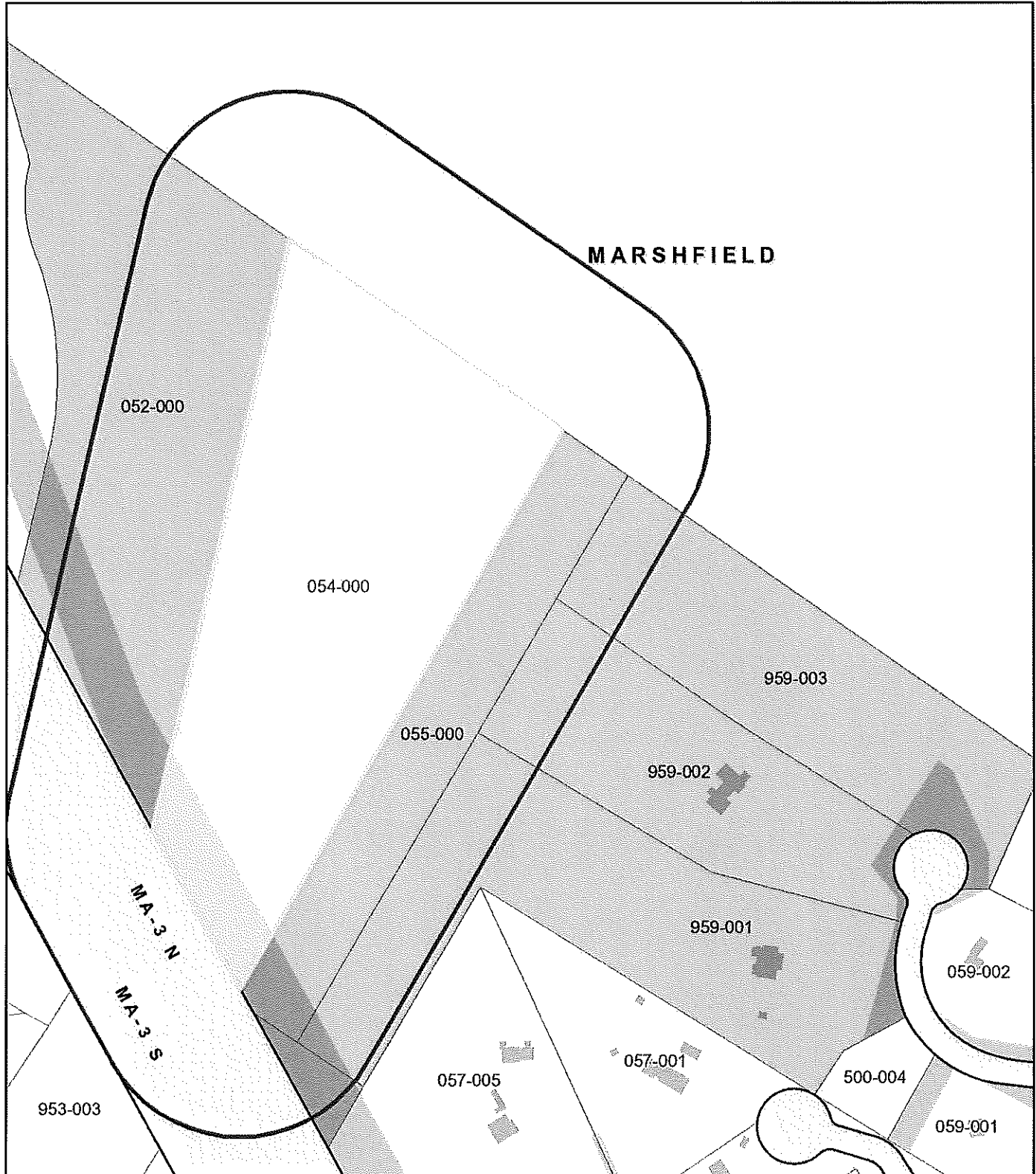

Data shown on this map is provided for planning and informational purposes only. The municipality and CAI Technologies are not responsible for any use for other purposes or misuse or misrepresentation of this map.



300 foot Abutters List Report

Duxbury, MA
January 06, 2022

Subject Property:

Parcel Number: 021-054-000
CAMA Number: 021-054-000-000
Property Address: 0 NORTH ST

Mailing Address: SPRAGUE CHARLES W & KRUEGER
MELISSA A SPENCE ROXANNE L EACH
1/3 INT
1406 WESTGLEN DRIVE
SACHSE, TX 75048

Abutters:

Parcel Number: 021-052-000
CAMA Number: 021-052-000-000
Property Address: 0 NORTH ST

Mailing Address: PHALEN J S & FLAHERTY A TT GEORGE
E PHALEN JR R E TRUST
34 CHICKERING RD
NORWOOD, MA 02062

Parcel Number: 021-055-000
CAMA Number: 021-055-000-000
Property Address: 0 NORTH ST

Mailing Address: MALLARD ROSE G TT PHILIP A
MALLARD IRREVOCABLE TRUST
19 PRESIDENTIAL DRIVE
WILMINGTON, MA 01887

Parcel Number: 021-959-001
CAMA Number: 021-959-001-000
Property Address: 10 HILLSIDE LN

Mailing Address: ZAFFIRO JILL E ZAFFIRO THOMAS J
10 HILLSIDE LN
DUXBURY, MA 02332

Parcel Number: 021-959-002
CAMA Number: 021-959-002-000
Property Address: 20 HILLSIDE LN

Mailing Address: TURCOTTE JENNIFER W
20 HILLSIDE LN
DUXBURY, MA 02332

Parcel Number: 021-959-003
CAMA Number: 021-959-003-000
Property Address: 30 HILLSIDE LN

Mailing Address: MCINTOSH JACK B MCINTOSH
SHANNON E
30 HILLSIDE LN
DUXBURY, MA 02332

Parcel Number: 022-500-053
CAMA Number: 022-500-053-000
Property Address: 0 NORTH ST

Mailing Address: DUXBURY TOWN OF
878 TREMONT ST
DUXBURY, MA 02332



www.cai-tech.com

Data shown on this report is provided for planning and informational purposes only. The municipality and CAI Technologies are not responsible for any use for other purposes or misuse or misrepresentation of this report.

DUXBURY TOWN OF
878 TREMONT ST
DUXBURY, MA 02332

MALLARD ROSE G TT
PHILIP A MALLARD IRREVOCA
19 PRESIDENTIAL DRIVE
WILMINGTON, MA 01887

MCINTOSH JACK B
MCINTOSH SHANNON E
30 HILLSIDE LN
DUXBURY, MA 02332

PHALEN J S & FLAHERTY A T
GEORGE E PHALEN JR R E TR
34 CHICKERING RD
NORWOOD, MA 02062

TURCOTTE JENNIFER W
20 HILLSIDE LN
DUXBURY, MA 02332

ZAFFIRO JILL E
ZAFFIRO THOMAS J
10 HILLSIDE LN
DUXBURY, MA 02332